



Ing. Michael Raab – Sales Director



Drupa 2016

We've touched the future
Unexpected success during the most important printing and packaging exhibition worldwide



26-29 SEPTEMBER 2016
POLAND

Taropak 2016

We've been there
Taropak confirm the importance of a fast growing eastern area.
Oppliger becomes market leader in Poland



CCE INTERNATIONAL
Corrugated & Carton Exhibition

CCE Munich 2017

Visit us during the CCE 2017 exhibition in Munich/Germany Hall B6 Stand 226 and have look in to the future

● ● ● Swiss Engineering
"Yes we can...
We've done it"

A NEW CONCEPT AIOL

All in one laminating
Making sheet to sheet Litho
Laminating more efficient
than inline solutions
Prefeeder and Logistics

NEWSLETTER OCTOBER 2016

Drupa 2016 - We've touched the future

Sintesy S³ - The full optional Sheet to Sheet Litho Laminator presented during DRUPA 2016

The fully automatic sheet to sheet laminating line Oppliger series Sintesy model 1616 S³ is a modern high-tech machine, which differs from the other on the market existing products through its technical characteristics

High Speed – Compact – Accuracy - Flexibility – Heavy Construction - Modular – Safety – Energy Saving

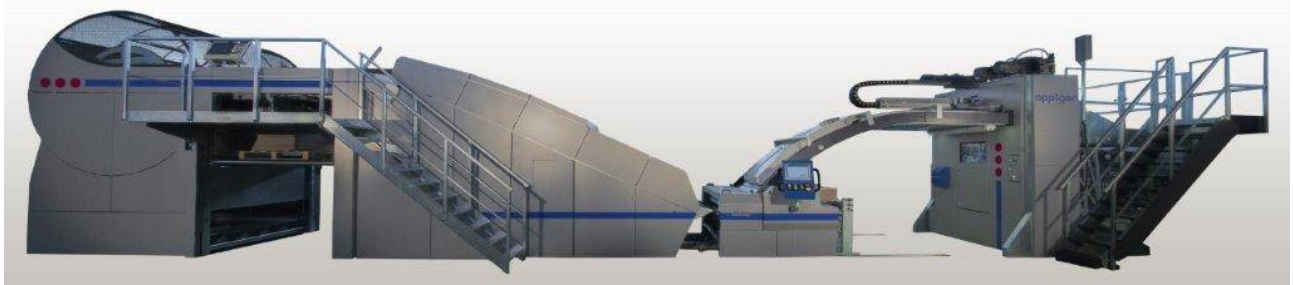

Sintesy 1616 S³

● ● ● Swiss Engineering



DRUPA 2016 High-Lights

- Edge to edge device
- Video control unit with cameras and monitor
- Router for teleservice
- "Two Steps Tool System"
- Innovative gluing unit to reduce glue consumption
- Led lights
- Special metallic colour version – Limited edition



Drupa 2016 has been for Oppliger an important investment, but the success was even more important as sales in different countries opened new market to the company.

Within the end of 2016 the company will settle over to a new facility in order to adapt to the increasing demand of the market.

Next step DRUPA 2020



stay connected

June 23 - July 03, 2020
Düsseldorf/Germany





Taropak 2016 - We've been there

After the big success in Taropak 2014 we decided to be also on the Taropak 2016 in Poznan Poland. Oppliger confirms the market leading position in the east European countries placing an important number of full optional sheet to sheet litho laminating lines in Poland, Czech Republic, Ukraine and other countries.

CCE Munich 2017

Visit us during the CCE 2017 from 21st to 23rd March 2017 exhibition in Munich/Germany in Hall B6 Stand 226 and have look in to the future.

We will show you our new concepts and solutions regarding sheet to sheet litho laminating, All in one laminating solutions, logistics and prefeeders, such as pallet normalizing systems in order to feed automatic diecutters with laminated materials in a fully automatic way.

AIOL - All in one laminating

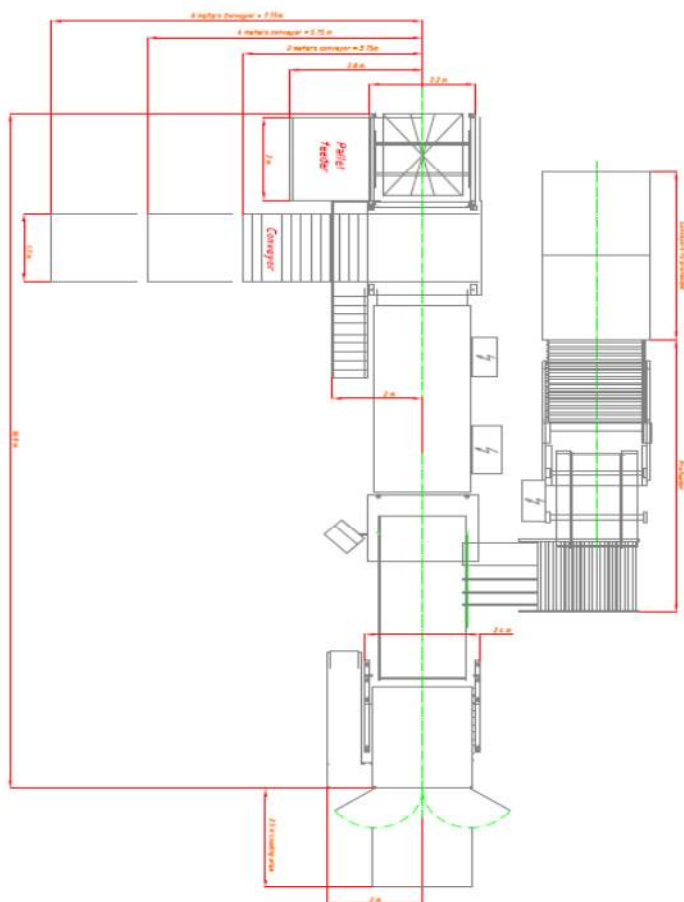



SINTESY – AIOL – ALL IN ONE LAMINATING

The new Oppliger concept combines your corrugated Wet-End with the Sintesy Laminating line and maintains the flexibility, and whenever needed, the independence between the corrugated Wet-End and the Sintesy Laminator, so that the user is able to choose between the following working processes:

1. Fully Automatic Inline Process

a. Corrugated Wet-End –Sheeter – Slitter –Stacker (Customer – external supplier)

The existing or to be installed corrugated Wet-End machine produces open flute, cuts it with the combined sheeter and side slitters to the desired format and builds the pile in the stacker without any need of wooden pallets.

The Wet-End machine can be installed parallel or transversal to the Sintesy Laminator as the intelligent logistic interface would be in case of need equipped with a special angle station for the rotation of the piles.

b. Intelligent Interface – Logistic – Prefeeder – Sintesy Laminator (Oppliger)

After the stacker there is a logistic system with a buffer system for at least 6 piles and which transports the piles with the open flute to the suction belt feeder of the Sintesy Laminating Line, where a shingled stream of sheets loads the feeder constantly and without any interruption.

2. Fully Automatic Offline Process

c. Corrugated Wet-End –Sheeter – Slitter –Stacker (Customer – external supplier)

The existing or to be installed corrugated Wet-End machine produces open flute, cuts it with the combined sheeter and side slitters to the desired format and builds the pile in the stacker on wooden pallets. These plies with sheets can be stocked in the magazine for external customers and sale or for later internal productions.

d. Sintesy Laminator (Oppliger)

While the corrugated Wet-End machine produces open flute for other or later uses the Sintesy laminating line will do other productions not suitable for an inline process, like covered flute, double flute or solid board as base materials.

This means that the user of the new AIOL (ALL IN ONE LAMINATING) concept will have the maximum flexibility of a sheet to sheet laminator and an inline solution:

Sheet to sheet laminating with all suitable material
Inline laminating with open flute
Separate open flute production for other or later uses



Second hand machines

We can offer the following second hand machines which we have in stock:

Ref. 132016 Scheggia RP 160 – Automatic Sheet to Sheet Litho Laminator
Age 2009, cleaned and checked, very good conditions



Ref. 142016 Grassi 142 – Fully Automatic Sheet to Sheet Litho Laminator with with Flip Flop device and Stacker
Age 1994, fully maintained, very good conditions



Ref. 152016 Grassi 125/1 – Folding Gluing machine with straight line, lock bottom and 4 corner device
Age 1993, very good condition, CE certificated in 2002

